

# 400 Series – New Construction LED

## FEATURES

- **Recessed New Construction**  
IC / Airtight / Chicago Plenum Rated
- **Adjustable Light Engine**  
0-35° Adjustable for Accent, Wall Wash, and General Lighting Applications
- **Flexible Installation**  
Accommodates ceiling thicknesses ranging from 1/2" – 5-1/2" without affecting aiming or adjustment
- **LED Options**  
Static White  
Warm Dimming
- **Optic Options**  
10°, 15°, 25°, and 40°
- **Optical Accessories**  
Five Beam Enhancing Lens Options  
Three Color Filtering Lens Options
- **Driver Options**  
INTEGRAL: Forward/Reverse Phase, 1-10V, DALI, EcoSystem
- **Trim Options**  
Flanged (for multiple ceiling types)  
Flangeless for Sheetrock  
Flangeless for Wood/Stone
- **Three Trim Lens Options**
- **Two Finish Options**
- **CA JA8 2025 Compliant**



## 400 NEW CONSTRUCTION LIGHT ENGINE

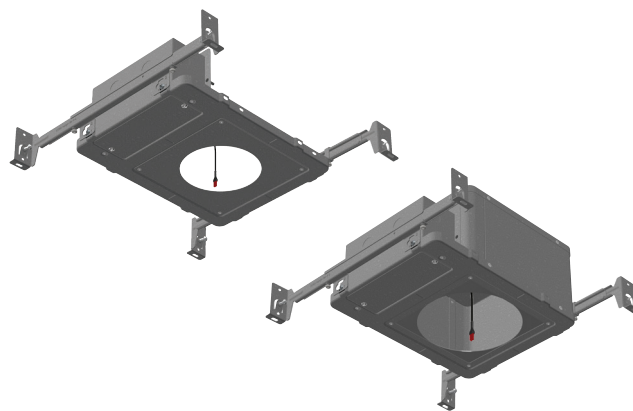

## 400 SERIES NEW CONSTRUCTION HOUSINGS

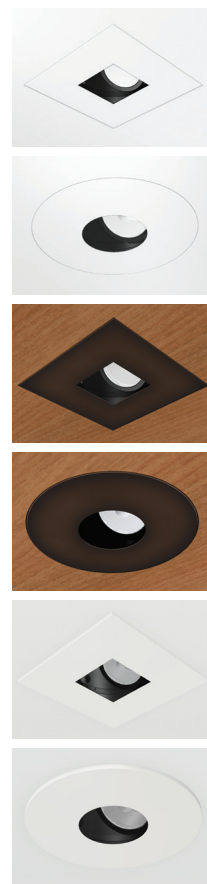

## 400 SERIES PERFORMANCE SUMMARY

	Static White		Warm Dimming		
	HI	HI-2	WD	WD-2	WD-4
LED Options					
Delivered Lumens	1037	1082	818	809	864
CRI	94	94	97	97	97
R9	60	63	82	78	76
Efficacy	74	75	56	55	59
CCT Options	2700K, 3000K		3000K, 1800K	2700K, 2200K	3000K, 2200K

Performance data shown with FLS-4 Trim.  
Static White data shown for 3000K.  
Warm Dimming data shown for 3000K and 2800K .



526 Portal Street  
Cotati, CA 94931  
USA  
P 707.794.0888  
www.8lighting.com

All No. 8 Lighting fixtures and components are UL Listed to both U.S. and Canadian requirements. No. 8 Lighting trims and lamp modules are protected by one or more U.S. Patents. No. 8 Lighting reserves the right to change details of design, materials, and finish.

© 2025 No. 8 Lighting



04/2025

93101-06