

# HOUSING: **804-I.C.** LAMP MODULE: **M2 – MIRROR REFLECTOR | LED**



Project Name	
Date	Type
Prepared By	
Comments	
Catalog # <b>804/M2-</b> – <b>HI</b> – – / / – <b>1400</b> /	



526 Portal Street  
Cotati, CA 94931  
USA  
P 707.794.0888  
F 707.795.4379  
www.8lighting.com

All No. 8 Lighting fixtures and components are UL/CSA listed. No. 8 Lighting trims and lamp modules are protected by one or more U.S. Patents. No. 8 Lighting reserves the right to change details of design, materials, and finish.

© 2020 No. 8 Lighting  
Doc # 91193-12.2

## PRODUCT FEATURES

### HOUSING

- **804** IC-Rated for direct contact with standard or spray-foam thermal insulation with a max combined R-Value of R49 (may also be installed in Non-IC applications). Meets Washington State Airtight Standard WAC 51-1-1-0502 and in accordance with ASTM E283 to reduce energy loss. CCEA plenum rated for City of Chicago environmental air spaces.
- Accepts **J2**, **K2**, and **M2** LED Lamp Modules and all **800 Series** Trim Assemblies. Note: Minimum 6" ceiling space required when used with INSET and BEVEL Series Trim Assemblies.

### Lamp Module

- **M2** Fully adjustable lamp module features 45-90° vertical and 90° horizontal adjustment. Use on sloped ceilings for adjustable accent, wall wash, and general lighting applications.
- Lamp module assembly includes either a SQUARE or ROUND trim plate for use with **800 Series Seamless** trims.

### LED Options

- **HI** 3000K 92+ CRI White LED. Minimum 2-Step color binning.

### Optic Options and Accessories

- Optic options include: 15°, 25°, and 40°.
- Optional beam enhancing lens accessories include: **NSP**-Narrow Softening, **NFL**-Medium Softening, **FL**-Wide Softening, **WFL**-Extra Wide Softening, and **LS**-Linear Spread.
- Optional color filtering lens accessories include: **CF24**-2400K, **CF27**-2700K, & **CF35**-3500K.

### Trim Finish Options

- Available finishes include: **WH** - White (field paintable to match ceiling finish) or **OB** - Oil-Rubbed Bronze.

### Dimming Options

- **PR1-8** Premium phase dimming LED driver with 120v/60Hz input. Dimmable to 0.1% using compatible Forward or Reverse-Phase dimmers.
- **EL1-8** EldoLED 0-10v LED dimming driver with 120-277v/60Hz input. Dimmable to 1% using compatible 0-10v dimmers.
- **EL2-8** EldoLED DALI dimming LED driver with 120-277v/60Hz input. Dimmable to 1% using compatible DALI dimmers.
- **LU1-8** Lutron Hi-Lume **LTEA2W** 1% 2-wire LED driver (120v Forward Phase only). 120v/60Hz input.

For a complete list of compatible dimmers, see [8lighting.com/resources-downloads](http://8lighting.com/resources-downloads)

### Output\*

- **1400** High output. Delivers up to 944 lumens.

\*Output may vary depending on optical accessories used.

For photometric files in PDF and IES formats, see [8lighting.com/800-series-photometry](http://8lighting.com/800-series-photometry)

### Mounting Accessories

- **BH** Bar Hangers for joist mounting.
- **BB** Butterfly Brackets for use with commercial c-channel or bar mounting.
- **TBC-BH** T-BAR Mounting Clips + Bar Hangers for T-Bar mounting.
- **PMB** Panel Mounting Brackets (set of two) for direct mounting to wood panels.

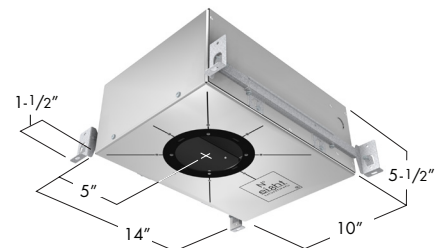

**804 - I.C. HOUSING**  
(shown with BH mounting accessory)



**M2-S**

**M2-R**

**M2 - LED MIRROR REFLECTOR**

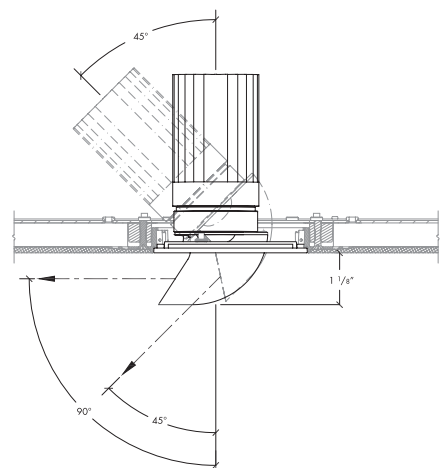

### LAMP MODULE M2 – TRIM ASSEMBLY CROSS SECTION DETAIL



**Note:** Cross sections are for illustration purposes only. Refer to housing installation instructions for complete installation details.

PRODUCT SPECIFIER/PRODUCT ORDER NUMBER

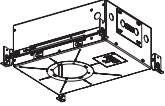
**804** / **M2-** - **HI** - / / - **1400** /

HOUSING	LAMP MODULE	LED OPTIONS	OPTIC OPTIONS	OPTICAL ACCESSORIES (Optional)	TRIM FINISH	DIMMING OPTIONS	OUTPUT	MOUNTING ACCESSORIES
 <p><b>804</b> New Construction – AIRTIGHT.H.C. 10"W* x 14"L* x 5 1/2"H Accepts All No. 8 Lighting LED Lamp Modules *Add 3" to length or width to accommodate mounting accessories</p>	<p>LED MIRROR REFLECTOR <b>M2-S</b> 4" SQUARE module w/ integral trim plate fits into square Seamless Series™ trim assemblies </p> <p><b>M2-R</b> 4" ROUND module w/ integral trim plate fits into round Seamless Series™ trim assemblies </p>	<p><b>HI</b> 3000K White LED</p>	<p><b>15</b> 15° Narrow Spot</p> <p><b>25</b> 25° Narrow Flood</p> <p><b>40</b> 40° Flood</p>	<p><b>NSP</b> Narrow Softening Lens</p> <p><b>NFL</b> Medium softening Lens</p> <p><b>FL</b> Wide Softening Lens</p> <p><b>WFL</b> Extra Wide Softening Lens</p> <p><b>LS</b> Linear Spread Lens</p> <p><b>CF24</b> 2400K Color Filtering Lens</p> <p><b>CF27</b> 2700K Color Filtering Lens</p> <p><b>CF35</b> 3500K Color Filtering Lens</p>	<p><b>WH</b> WHITE</p> <p><b>OB*</b> OIL-RUBBED BRONZE *Specially finish</p>	<p><b>PR1-8</b> Premium Forward or Reverse-Phase 0.1% Dimming</p> <p><b>EL1-8</b> EldoLED 0-10v 1% Dimming</p> <p><b>EL2-8</b> EldoLED DALI 1% Dimming</p> <p><b>LU1-8</b> Lutron Hi-Lume Forward-Phase 1% Dimming</p>	<p><b>1400</b> High output</p>	<p><b>BH</b> Bar Hangers</p> <p><b>BB</b> Butterfly Brackets</p> <p><b>TBC-BH</b> T-Bar Mounting Clips + Bar Hangers</p> <p><b>PMB</b> Panel Mounting Brackets</p>

**Optic Option and Accessory Notes**

One field interchangeable optic option included standard. Up to two additional optical accessories can be accommodated.

**Trim Finish Notes**

White trim finish is field paintable to match ceiling color. Lot variations may occur with specialty finishes. Ordering ALL trim kits at the same time is recommended to minimize finish variations.

**Installation Notes**

Ambient temperatures in ceiling space should not exceed 25°C (77°F) during normal operation.

**Warranty**

All No. 8 Lighting products are by a 5-year limited warranty. For specific warranty details and limitations, see [8lighting.com/resources-downloads](http://8lighting.com/resources-downloads)

**804/M2 PERFORMANCE SUMMARY**

LED	Output	CCT	CRI	Delivered Lumens	System Wattage	Delivered LPW	R1	R2	R3	R4	R5	R6	R7	R8	R9	R10	R11	R12	R13	R14
HI	1400	3000	92+	755-944	20.7	37-46	92.8	98.3	97.0	90.7	92.5	97.3	89.4	79.0	54.7	94.9	91.9	82.1	94.6	99.2

**OPTICAL OPTIONS AND ACCESSORY PERFORMANCE SUMMARY**

OPTICAL OPTIONS	BEAM ENHANCING LENS (OPTIONAL)*				
	+ NSP	+ NFL	+ FL	+ WFL	+ LS
15° Spot	20°	27°	42°	61°	19 x 47°
25° Narrow Flood	27°	34°	47°	67°	26 x 52°
40° Flood	41°	42°	56°	68°	36 x 57°
<i>Lens Lumen Multiplier</i>	0.93	0.87	0.88	0.82	0.89

\*Beam enhancing lens used in combination with 15°, 25°, or 40° optic to achieve desired beam spread